

P50 RGB

Multicolor LED beacon developed with a multichannel technology. **P50 RGB** allows steady light in seven different colors. **P50 RGB A**: Multicolor LED sounder providing a continuous sound.

Versions available with QC M12 connector or M12 cable gland.

Voltages

24V ACDC +/-10%

Mechanical features

Self-extinguishing PC body totally protected against vibrations, dust and atmospheric elements. EPDM o-ring on dome and polyuretanic gasket on base. Can be panel mounted through a M22 hole and secured with the locking ring provided. Electrical connection through QC M12 4 PIN connector or M12 cable gland.

Optical features

6 bright **RGB** LEDs. Polycarbonate opaline dome for a smooth coloring of the device according to the selected color. Steady light in different colors (white, red, yellow, green, magenta, blue).

Certifications

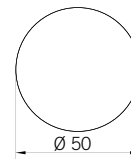
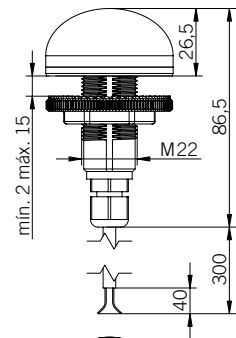
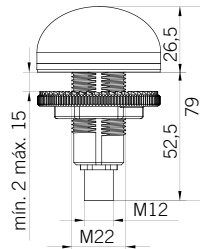

P50 RGB QC M12

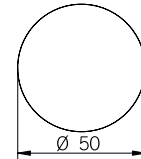

P50 RGB A



P50 RGB QC M12



P50 RGB



80 dB max.



P50 RGB A QC M12

P50 RGB A

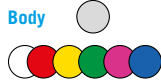
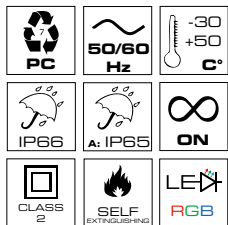

Codes

P50 RGB QC M12

24V DC 91430

P50 RGB

24V DC 91379

Codes

P50 RGB A QC M12

24V DC 91429

P50 RGB A

24V DC 91380

